

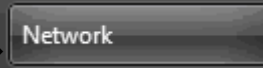

1. On the Windows *Desktop*, click  →  .
2. In the *Network* Window, click **Network and Sharing Center**.
3. In the *Network and Sharing Centre* Window, click **Set up a connection or network**.
4. In the *Set up a connection or network* Window, click **Connect to the Internet** option and click **Next** button to proceed.
5. In the *Connect to the Internet* Window, click **Broadband (PPPoE)**. If **Broadband (PPPoE)** is not found, click the checkbox **Show connection options that this computer is not set up to use**.
6. In the *Type the information from your Internet service provider (ISP)* Window, enter your student ID as the **User name** and your own personal password in the **Password** text box. Enter SRH as **Connection name** and check the option **Allow other people to use this connection**. Click the **Create** button.

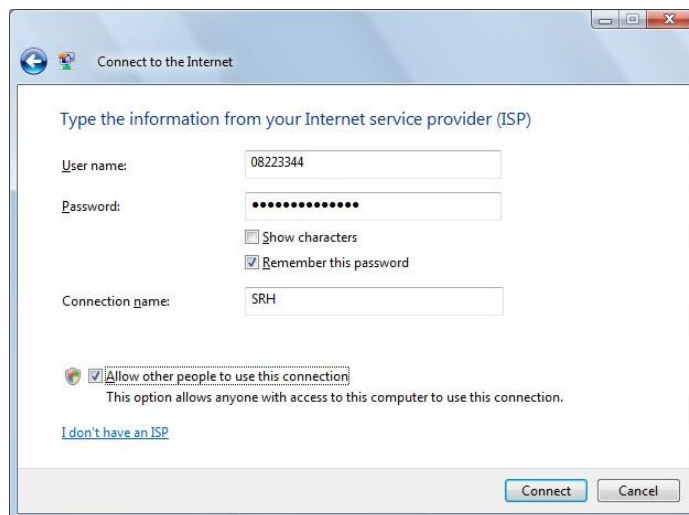

7. In *The connection to the Internet is ready to use* Window, click the **Close** button to complete your set up. If *The Internet connectivity test was unsuccessful* appeared, select the **Set up the connection anyway** and click the **Close** button.

8. To make a connection to the SRH Network, click  →  . In the *Connect to a network* Window, click **SRH PPPoE Connection** and click **Connect** button. After the *Connect SRH* Window, click **Connect** button. You can surf the Internet after then.

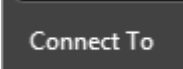
For enquiry, please contact Service Call Centre at 34117899, or email hotline@hkbu.edu.hk.