

Add Multiple Mobile Devices for Common / Project Account

You may add multiple devices for common / project account for verification purpose.

 Tips: only **ONE** device of your choice can receive Duo Push at a time.

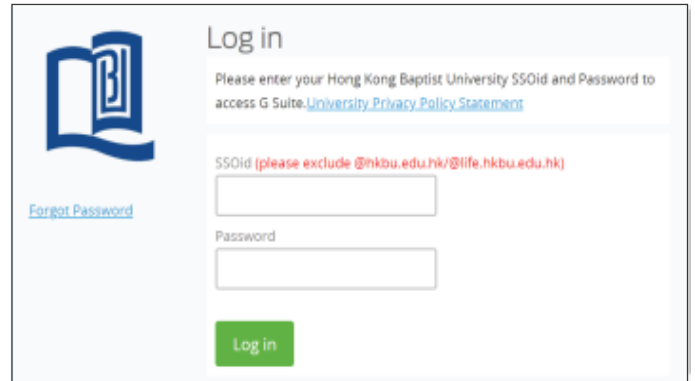
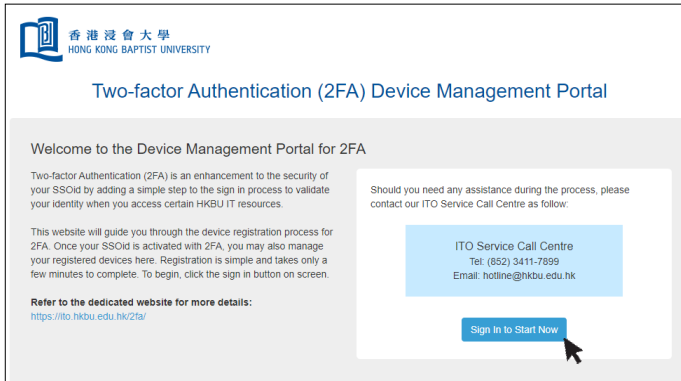

1 Log on the **Device Management Portal** (<https://iss.hkbu.edu.hk/buam/DuoDmp/welcome.seam>) and click 'Sign In to Start Now' button to sign in using SSOid and password.

2 For security reasons you will be prompted to confirm your identity via 2FA. Follow the on-screen instructions to proceed.

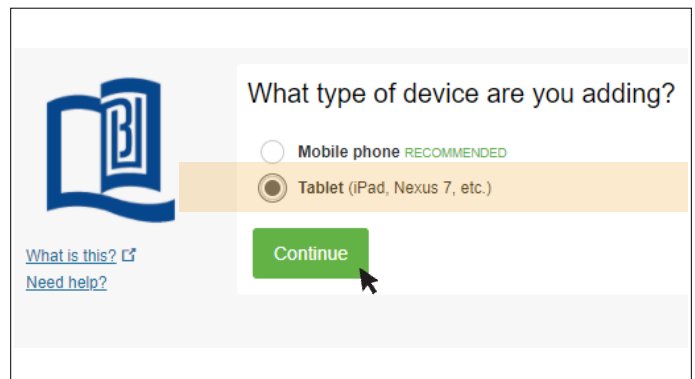
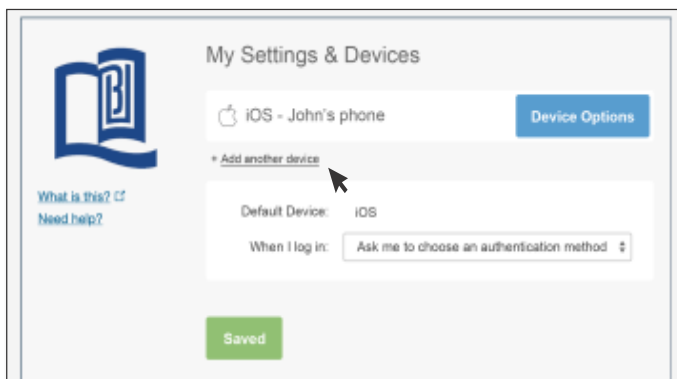

3 Upon successful verification, you will see a list of registered devices under 'My Settings & Devices'. Click '+ Add another device' link.

4 Select 'Tablet' (even if you're using a smartphone) and click 'Continue'.

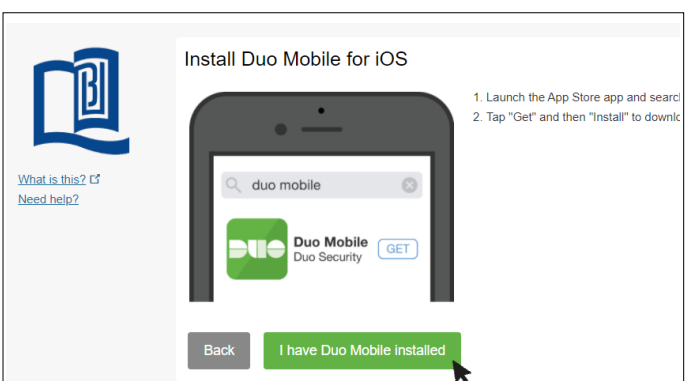
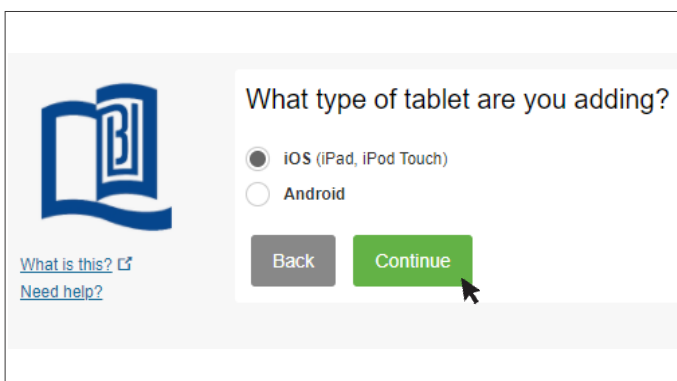

5 Select OS type of your smartphone and click 'Continue'.

6 A Duo Mobile activation QR code will display on your PC's screen after click 'I have Duo Mobile installed'.

Tips: Select iOS on the Apple device or Android on another supported device.

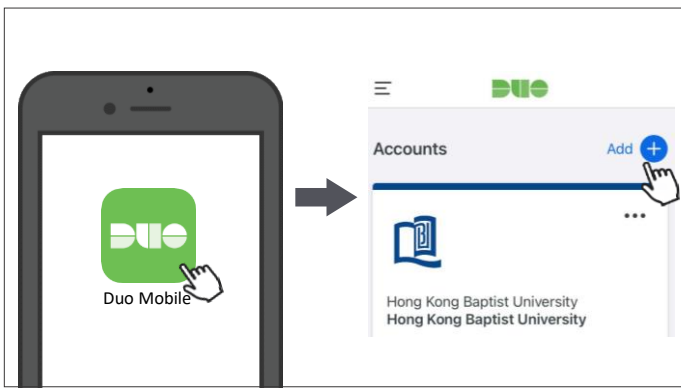

7 Click the **Duo Mobile** app on your smartphone. Click **'Add +'** to add a new account.

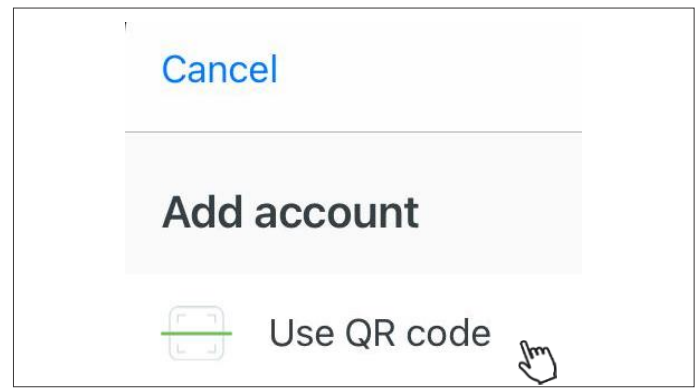

8 Click **'Use QR code'** button.



9 Scan the **QR code** on your PC's screen using your smartphone.

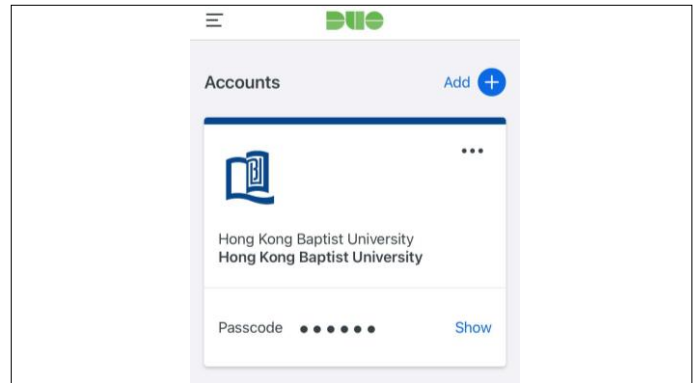

10 The new account will add to the app. Tips: **Keep** it on your smartphone for future logins.

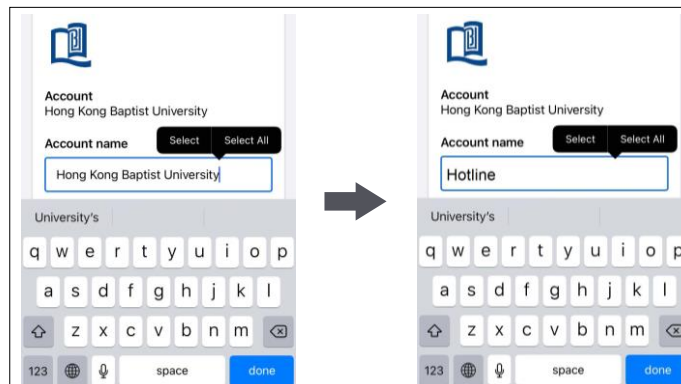

11 Provide a new name for the new account and click **done** to confirm the changes on the Duo Mobile app.

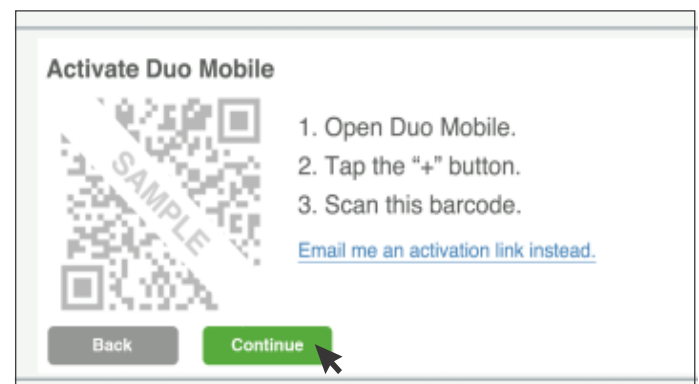

12 Once the QR code is accepted, the **'Continue'** button will be enabled and click it to continue on the browser.

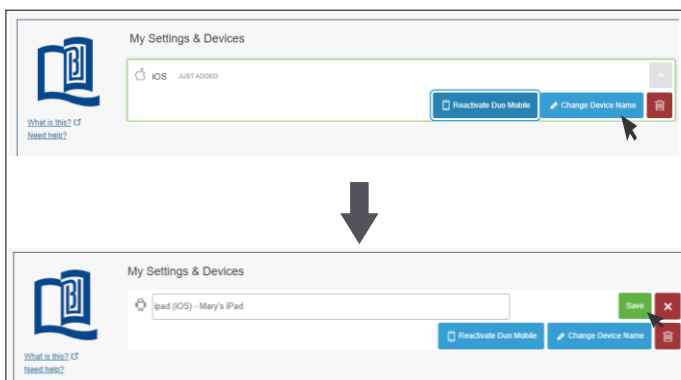

13 Provide a new name (e.g. Mary Mobile or SSOid) for the registered device and click **'Save'** button to confirm the changes and complete the process.

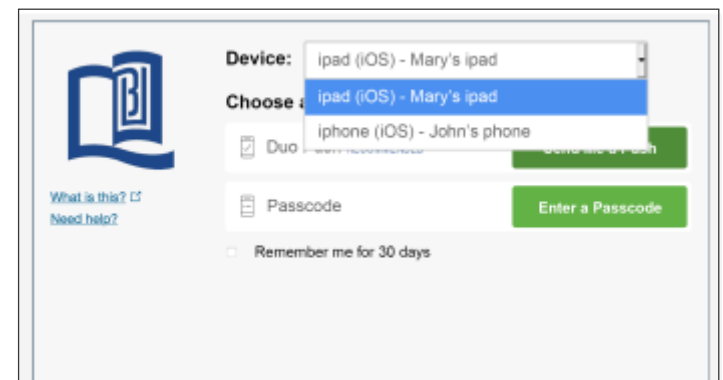

✓ Tips: Once you have registered additional devices, you will be able to select a preferred device for receiving Duo Push in the future.